



Delivery includes:

- 1 x RAM MOUNT Ball 1"
- 1 x Adapter
- 1 x Screw M8x40

Necessary Tools:

- 1 x Plastic patel for car parts
- 1 x Socket wrench 8mm
- 1 x Allen Key No. 6
- 1 x Diagonal Cutter (Stable Edition)

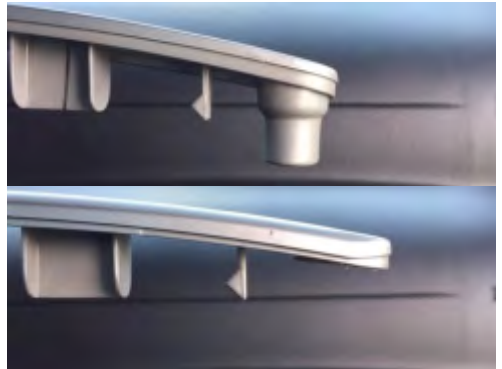

1. Step :

Carefully remove the panel of the passenger handle from below with plastic patel. Panel is only plugged in.

2. Step:

Remove the decoration screw (on the side you would like to) from the panel and change the panel according to the pictures.



3. Step:

Using the socket wrench 8mm remove the fixing screw.

4. Step:

Cut the washers of the original screw off by using the diagonal cutter. Insert the screw into the JK Adapter.



5. Step:

Use the original screw and insert the Adapter into the handle and tighten it.



Then insert the modified panel into the handle. On the side where you installed the Adapter do NOT push it fully in!



6. Step:

Insert the RAM MOUNT Ball with the M8*40 screw into the Adapter. Press the panel into its place.